

Date: _____ Location: _____
 Product: _____ Project: _____
 Quantity: _____ Catalog #: _____

LED Multi Watt Multi CCT V2 Down



6"

7W, 10W and 18W



8"

10W, 15W and 22W



9.5"

20W, 25W and 32W



FEATURES

- Commercial grade
- IP44 rated
- Wattage selectable
- CCT selectable
- CRI 90
- 50,000 hours lifetime

SUITABLE APPLICATIONS

- Kitchens
- Bedrooms
- Bathrooms
- Corridors
- Hallways
- Museums

CONSTRUCTION:

Downlight body and endcaps are both fabricated from aluminum for maximum rigidity. Lightweight aluminum heat sink designed to perform naturally convective cooling.

OPTICAL SYSTEM:

Lumiled LED chips. General, medium, aisle distributions available to meet both horizontal and vertical light level requirements. 90° beam angle

WARRANTY:

5-year limited warranty. Actual performance may differ as a result of end-user environment and application.

ELECTRICAL:

Uses a -20°C to 40°C (-4°F to 104°F) case temperature drive. 0.90 power factor. Available as 120-277V input.

INSTALLATION & MOUNTING:

Use torsion spring clips to install in place.

DIMMING:

Dimmable range from 0-10V.



MODEL NUMBER – 3,000K 3,500K 4,000K	WATTAGE	LUMENS	EFFICACY	CRI	POWER FACTOR	REPLACES
LOC-6DL-MW-MCCT-V2	7W / 10W / 18W	700LM / 1,000LM / 1,500LM	83.3LM/W	94	0.98	60W / 100W / 150W
LOC-8DL-MW-MCCT-V2	10W / 15W / 22W	1,000LM / 1,500LM / 2,000LM	90.9LM/W	94	0.97	100W / 150W / 200W
LOC-9.5DL-MW-MCCT-V2	20W / 25W / 32W	2,000LM / 2,500LM / 3,000LM	93.8LM/W	94	0.99	200W / 250W / 300W

Energy Star ID:

- LOC-6DL-MW-MCCT-V2 - 2357834
- LOC-8DL-MW-MCCT-V2 - 2357835
- LOC-9.5DL-MW-MCCT-V2 - 2357836

Series	Size	Wattage Options	CCT Options	Version
LOC-DL	6" 8" 9.5"	7W / 10W / 18W 10W / 15W / 22W 20W / 25W / 32W	3,000K 3,500K 4,000K	V2 = Version 2

MEASUREMENTS

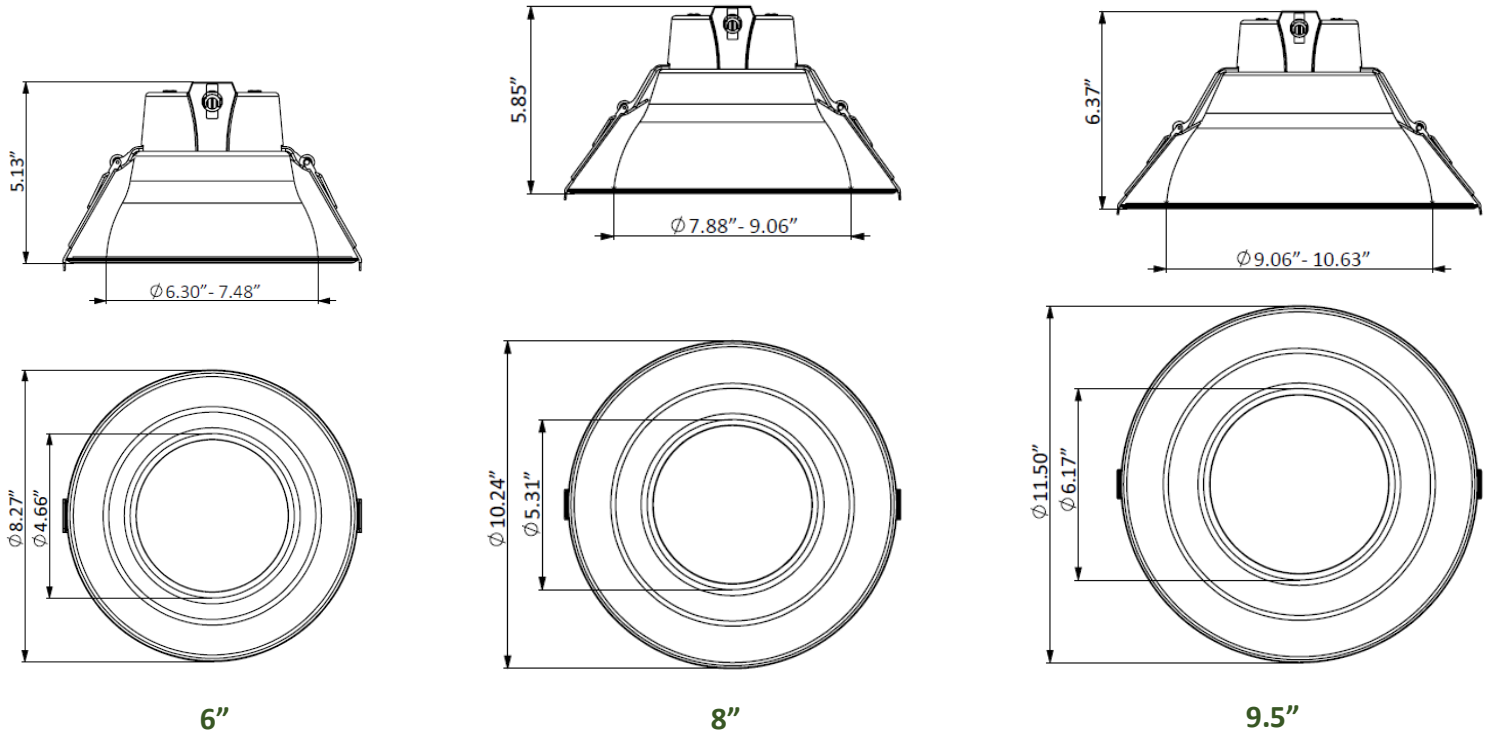

MODEL	QUANTITY	WEIGHT	UPC CODE
LOC-6DL-MW-MCCT-V2	1	1.30 lbs	00815586021789
LOC-8DL-MW-MCCT-V2	1	1.51 lbs	00815586021901
LOC-9.5DL-MW-MCCT-V2	1	1.75 lbs	00815586021918

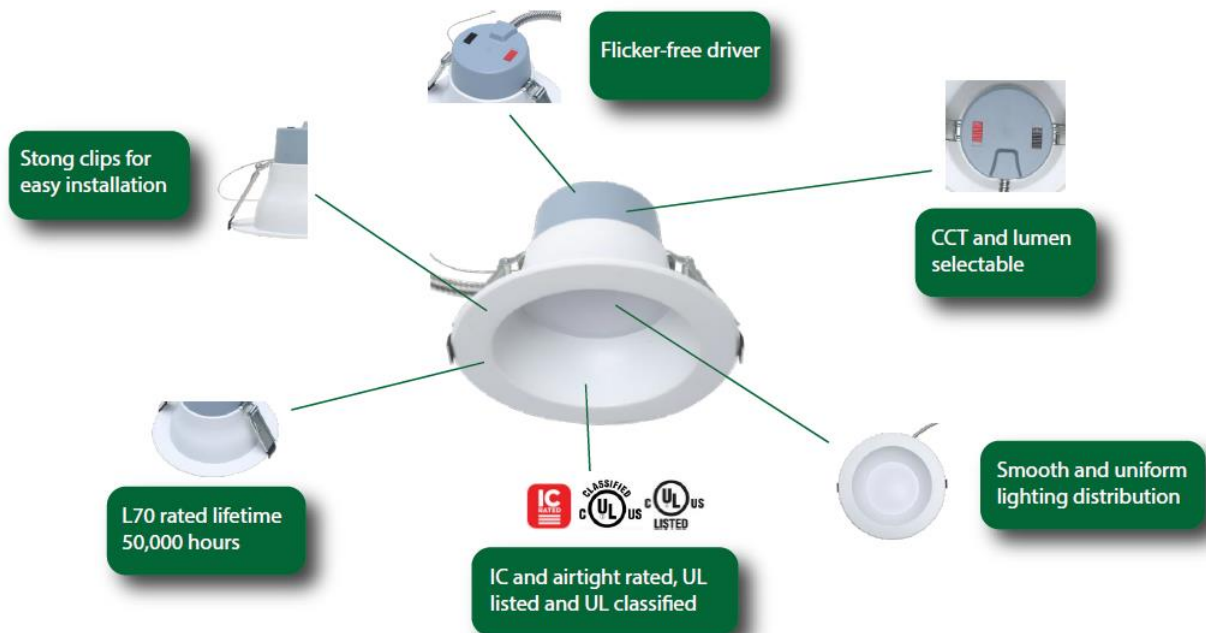

PHOTOMETRIC DATA

6"

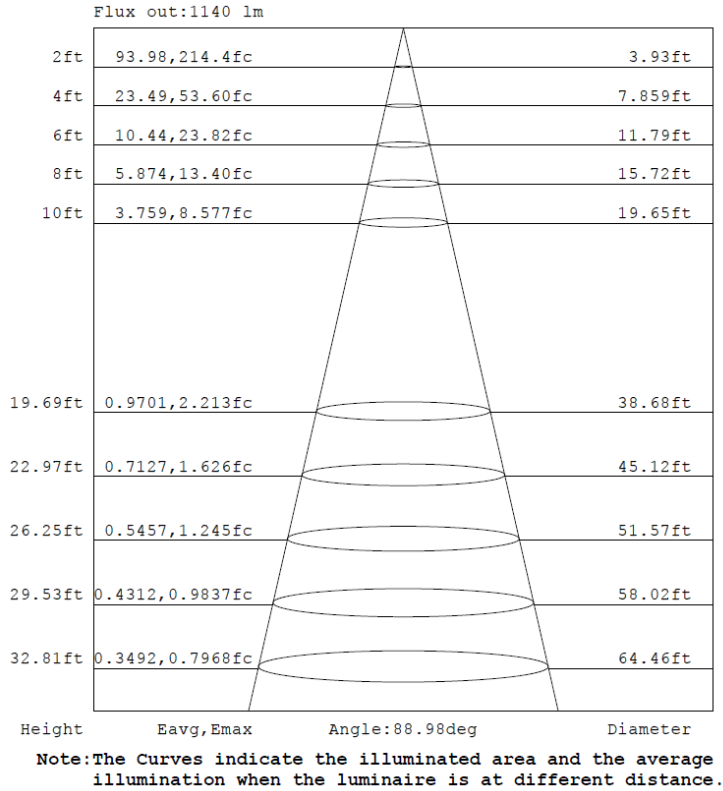
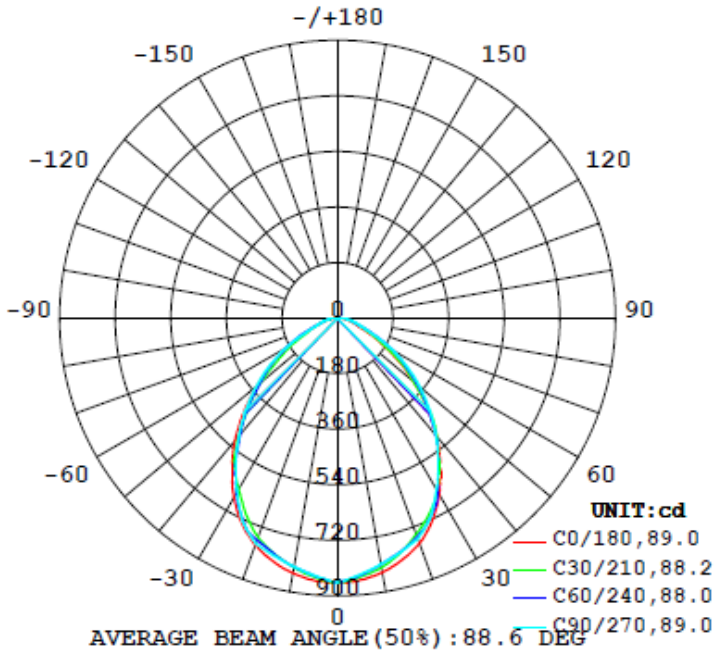

8"

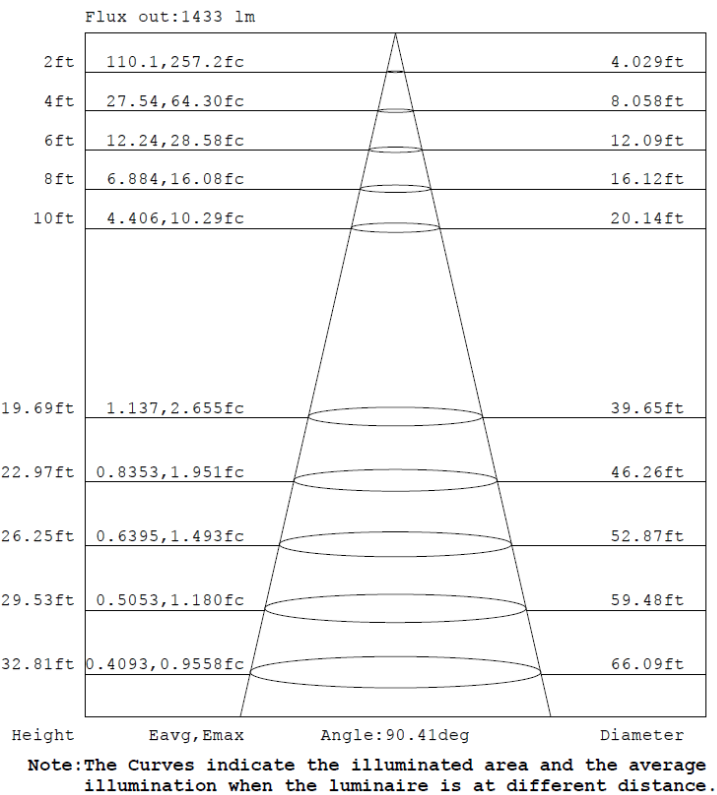
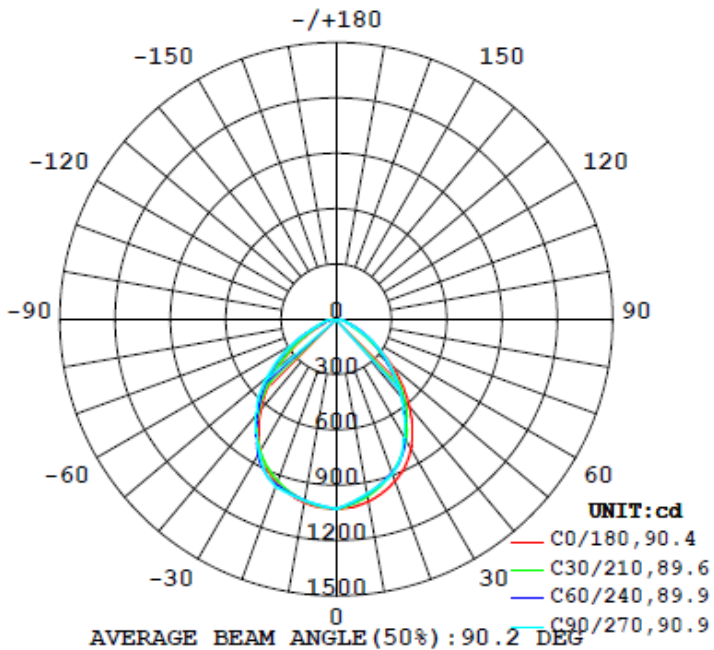

PHOTOMETRIC DATA

9.5"

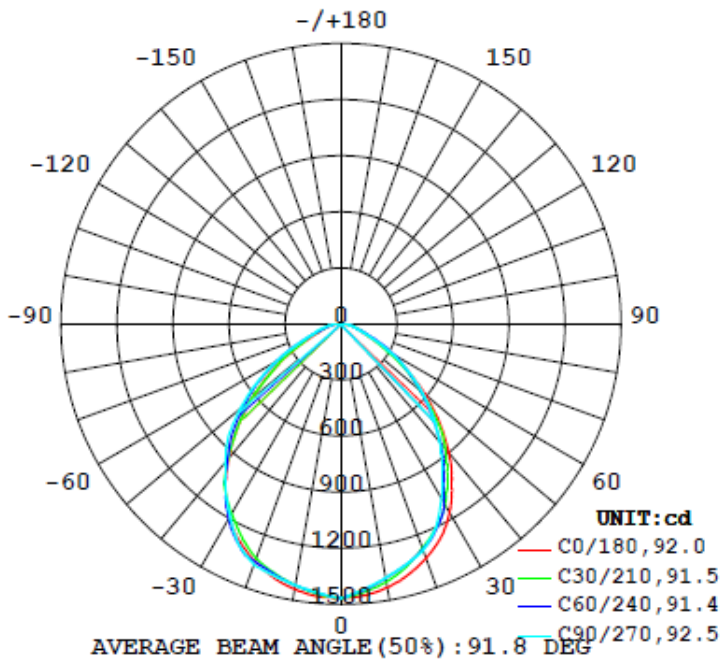

Flux out: 2127 lm

Height	Eavg, Emax	Angle: 92.05deg	Diameter
2ft	152.4, 366.8fc		4.146ft
4ft	38.10, 91.70fc		8.292ft
6ft	16.93, 40.75fc		12.44ft
8ft	9.525, 22.92fc		16.58ft
10ft	6.096, 14.67fc		20.73ft
19.69ft	1.573, 3.786fc		40.81ft
22.97ft	1.156, 2.782fc		47.61ft
26.25ft	0.8849, 2.130fc		54.41ft
29.53ft	0.6992, 1.683fc		61.21ft
32.81ft	0.5663, 1.363fc		68.01ft

Note: The Curves indicate the illuminated area and the average illumination when the luminaire is at different distance.

OPTIONAL ACCESSORIES



Emergency Driver

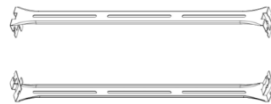

Mounting T-Bar Kit for Emergency Driver